

SPECIFICATION SHEET MODEL 880/880V



REDUCED PRESSURE ASSEMBLY

Physical Properties

Size of Mainline	2 1/2", 3, 4", 6", 8", & 10"
Max. Working Pressure	175 PSI (1200 KPa)
Hydrostatic Test Press.	350 PSI (2400 KPa)
Temperature Range	32° F to 140° F (0° C to 60° C)
End Connections	Flanged ANSI B16.1 Class 125

U.S. Patent No. 4,989,635 • U.S. Patent No. 5,107,888
 U.S. Patent No. 5,385,166 • U.S. Patent No. 5,226,441
 U.S. Patent No. 5,392,803 • U.S. Patent No. 5,503,176

Materials

Main Valve Body	Ductile iron Grade 65-45-12
Coating	Fusion epoxy coated internal and external AWWA C550-90
Shut Off Valves	NRS and OS&Y resilient wedge gate valves AWWA C509
Trim	Bronze
Elastomer Discs	EPDM
Spring	Stainless steel

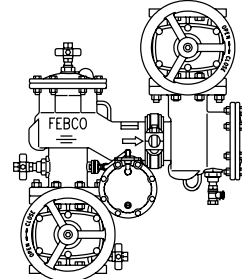

MODEL 880V REDUCED PRESSURE ASSEMBLY
(Shown in vertical orientation)

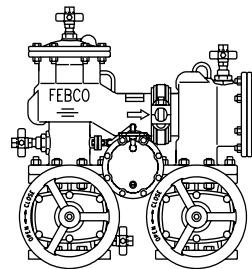

MODEL 880/880V REDUCED PRESSURE ASSEMBLY
(Shown in standard orientation)

Installation Views

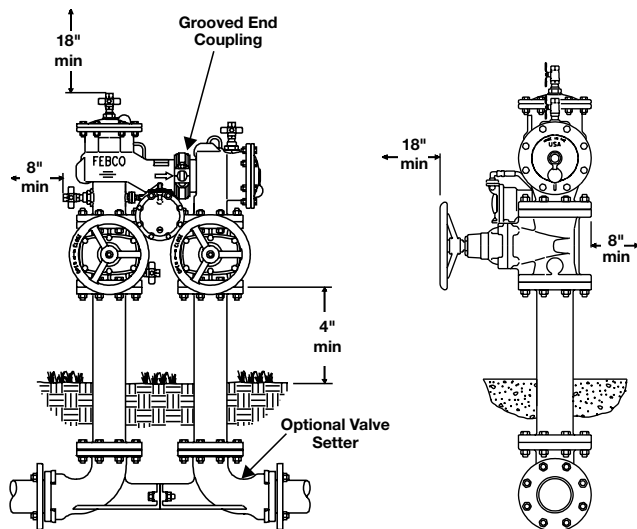

Standard orientation (Model 880*/880V)

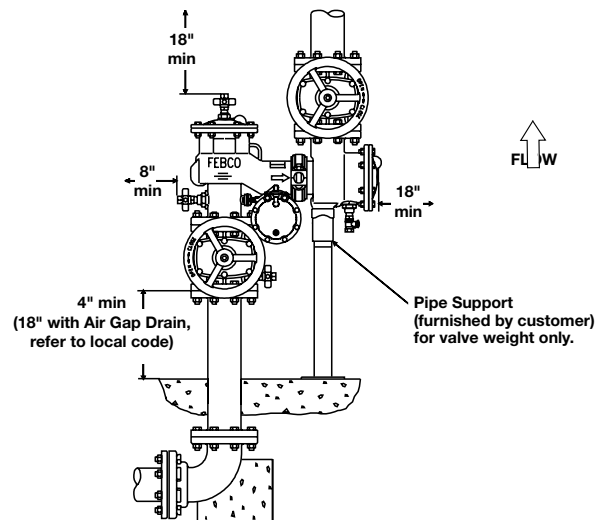

Vertical orientation (Model 880V)

* Note-Model 880 does not include grooved end coupling.

** Adaptor supplied with 880V only.

Recommended minimum clearances from permanent structures for ease of testing and maintenance are shown on above drawings.

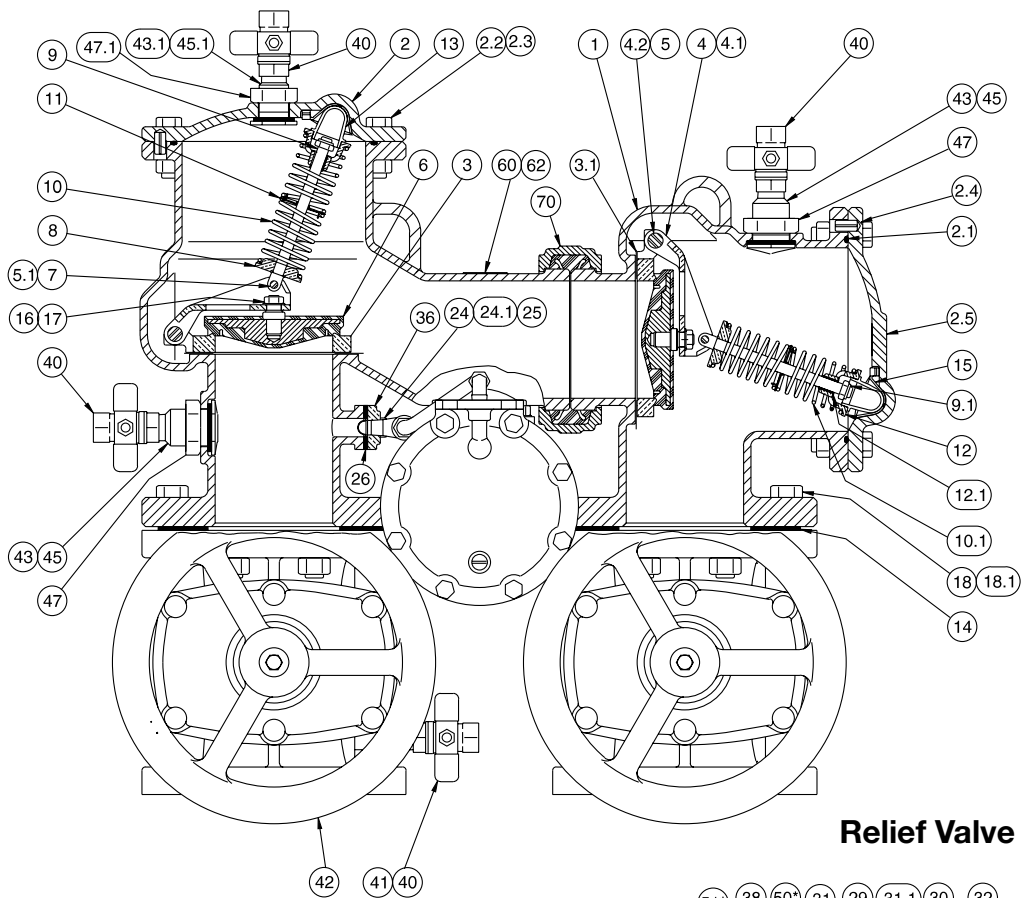

10" Disc Assembly

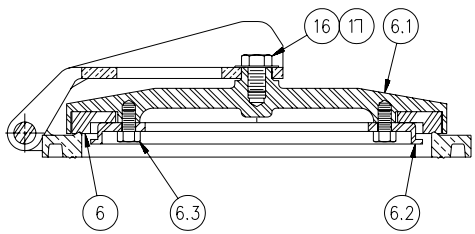

Relief Valve Detail

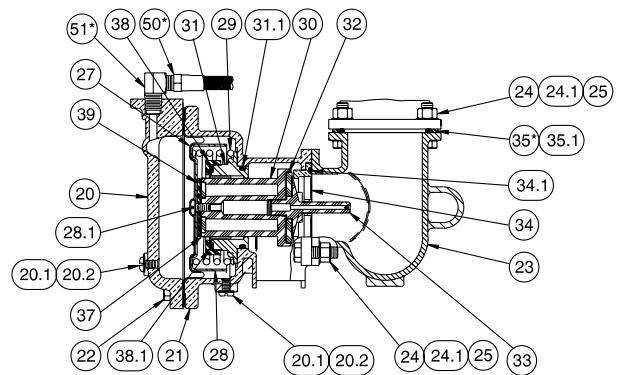

Materials of Construction

ITEM	DESCRIPTION	MATERIAL	ITEM	DESCRIPTION	MATERIAL	ITEM	DESCRIPTION	MATERIAL
1	Body	A536 GR 65-45-12	12	Upr Spring Retnr	Alloy	32	Seat Disc - RV	EPDM ASTM D2000
2	Cover 1 st Check	A536 GR 65-45-12	12.1	Bushing-Spr. Stem	Acetal Resin	33	Lower Guide	Acetal Resin
2.1	O-Ring	EPDM ASTM D2000	13	Pivot Bearing	Alloy	34	Seat Disc	Alloy
2.2	Capscrew	Plated Steel	14	Flange Gasket	Rubber/Fabric	34.1	O-Ring	FDA EPDM
2.3	Hex Nut	Plated Steel	15	Bearing Socket	Acetal Resin	35	O-Ring	Acetal Resin
2.4	Expansion Pin	SS	16	Hex Jam Nut	SS	35.1	Back-Up Ring	EPDM ASTM D2000
2.5	Cover 2 nd Check	A536 GR 65-45-12	17	Washer	SS	36	Adaptor Plate	Alloy
3	Seat Ring	B584 Alloy C83600	18	Flange Bolt	Plated Steel	37	Sm. Diaphragm	Nitrile ASTM D2000
3.1	Gasket	EPDM ASTM D2000	18.1	Flange Nut	Plated Steel	38	Retainer	Alloy
4	Arm	B584 Alloy C83600	20	R.V. Cover	Alloy	38.1	Slip Ring	Acetal Resin
4.1	Bushing Swing Pin	Acetal Resin	20.1	Bleed Screw	SS	39	Flow Washer	Acetal Resin
4.2	Swing Pin	SS	20.2	Gasket	HDPE	40	Ball Valve	Alloy
5	Retaining Clip	SS	21	R.V. Body	Alloy	41	Nipple	Brass
5.1	Hairpin Cotter	SS	22	Cover Bolt	SS	42	Gate Valve	AWWA C509
6	Check Disk	EPDM Coated GR, 45	23	Elbow	A536 GR 65-45-12	43	Bulkhead Fitting	Alloy
6.1	Disk Holder (10")	Ductile Iron w/ SS Stem	24	RV Mtg Bolt	Plated Steel	43.1	Bulkhead Fitting	Alloy
6.2	Disk Retainer (10")		24.1	Washer - RV	Plated Steel	45	Gasket	EPDM ASTM D2000
6.3	Capscrew (10")		25	RV Mtg Bolt	Plated Steel	45.1	Gasket	EPDM ASTM D2000
7	Load Pin	SS	27	Lrg. Diaphragm	Nitrile ASTM D2000	47	Nut	Alloy
9	Spring Stem	SS	28	Button	A240 304 SS	50	Sensing Line	SAE Hydraulic Hose
9.1	Elastic Stop Jam Nut	SS	28.1	Flow Screw	Acetal Resin	51	Street Elbow	Alloy
10	Spring 1 st Check	SS	29	RV Spring	SS	60	Identification Plate	Alloy
10.1	Spring 2 nd Check	SS	30	Stem - RV	Acetal Resin	62	Drive Screw	SS
11	Spring Guide	SS	31	Main Guide - RV	Alloy	70	Clamp (880V)	AWWA C606
			31.1	O-Ring - RV	FDA EPDM			

**Model 880/880V
Standard Orientation**

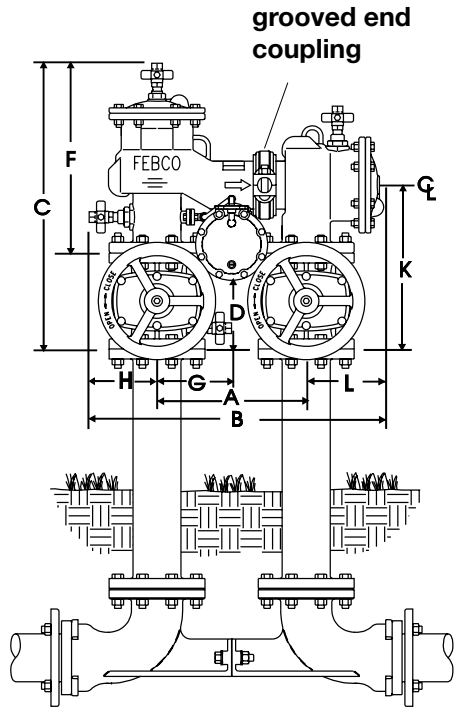

Note: The Model 880V is shipped in the standard (N-Shape) orientation as shown above. Model 880 does not include grooved end coupling.

**Model 880V
Vertical Orientation**

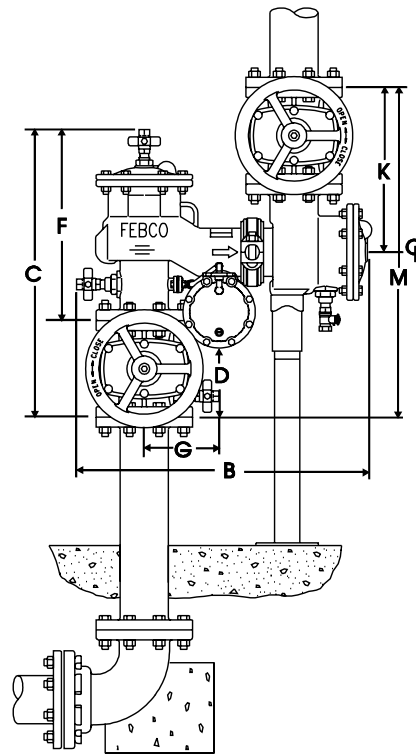

NRS Side View

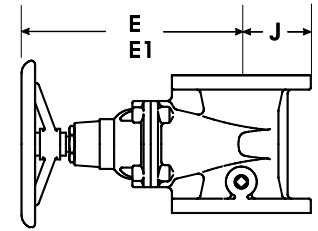

Relief Valve Detail

Relief shipped on right side (shown)
field reversible to left side.

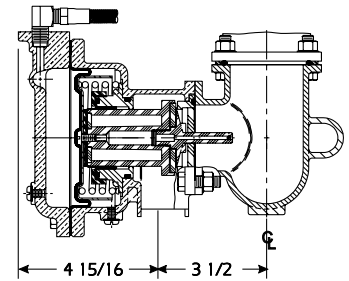

Dimensions

U.S. - Inches

Size	A	B	C	D	E NRS	E1 OS&Y OPEN	F	G	H	J	K	L	M	Approximate	
														Net NRS (Lbs.)	Net. OS&Y (Lbs.)
2 1/2"	12 1/2	25 3/4	24 1/4	4 15/16	12 5/8	16 3/8	16 5/8	6 1/4	5 1/2	3 1/2	13 5/8	7 1/4	27 1/4	210	220
3"	12 1/2	25 3/4	24 3/4	5 7/16	12 7/8	22 1/4	16 5/8	6 1/4	5 1/2	3 3/4	14 1/8	7 1/4	28 1/4	280	290
4"	14	27 7/8	26 3/4	6 9/16	14 3/8	23 1/4	17 3/4	7	6	4 1/2	15 1/2	7 1/4	31	320	350
6"	16	32 1/4	32 1/4	8 9/16	18 7/8	30 1/8	21 4/7	8	7 1/2	5 1/2	18 5/8	9 1/2	37 1/4	480	530
8"	18 1/2	37 1/2	36 3/8	9 9/16	23 1/2	37 3/4	24 7/8	9 1/4	8 3/4	6 3/4	20 3/4	10 1/4	41 1/2	810	880
10"	21	42 1/2	40 3/4	11 1/2	27 1/2	48	27 1/2	10	9 3/4	8	24	11 1/2	48	1350	1480

Metric - MM

Size	A	B	C	D	E NRS	E1 OS&Y OPEN	F	G	H	J	K	L	M	Approximate	
														Net NRS (kgs.)	Net. OS&Y (kgs.)
65	317.5	654.1	616.0	125.4	320.7	415.9	422.3	158.8	139.7	88.9	346.1	184.2	692.2	95.3	99.8
80	317.5	654.1	628.7	138.1	327.0	565.2	422.3	158.8	139.7	95.3	358.8	184.2	717.6	127.0	131.5
100	355.6	708.0	679.5	166.7	365.1	590.6	450.9	177.8	152.4	114.3	393.7	184.2	787.4	145.1	158.8
150	406.4	819.2	819.2	217.5	479.4	765.2	547.9	203.2	190.5	139.7	473.1	241.3	946.2	217.7	240.4
200	469.9	952.5	923.9	242.9	596.9	958.9	631.8	235.0	222.3	171.5	527.1	260.4	1054.1	367.4	399.2
250	533.4	1079.5	1035.1	292.1	698.5	1219.2	698.5	254.0	247.7	203.2	609.6	292.1	1219.2	612.3	671.3

Weights do not include risers or optional valve setter.

Note: Dimensions shown are nominal. Allowances must be made for normal manufacturing tolerances. Refer to Specification Sheet SS VS for details on valve setter.

Application

Health Hazard

Flow Orientation

Standard orientation is inlet flow vertical up, outlet flow vertical down. Vertical orientation is inlet and outlet flow vertical up.

Options

- Valve Setter with MJ x MJ, MJ x FL, or FL x FL ends
- UL/FM OS&Y RW Gate Valves
- Relief Valve Air Gap Drain Funnel
- Wye Strainer

Agency Compliance (Sizes 2 1/2"-10")

- ASSE (Std 1013)
- ANSI/AWWA (C511-89)
- CAN/CSA (B64.4)
- UL*
- FM*
- cUL
- Approved by the Foundation for Cross Connection Control and Hydraulic Research at the University of Southern California.

* Less gate not FM approved.
Less gate not UL listed unless installed with UL listed gated valves.

Model 880/880V Flow Curves

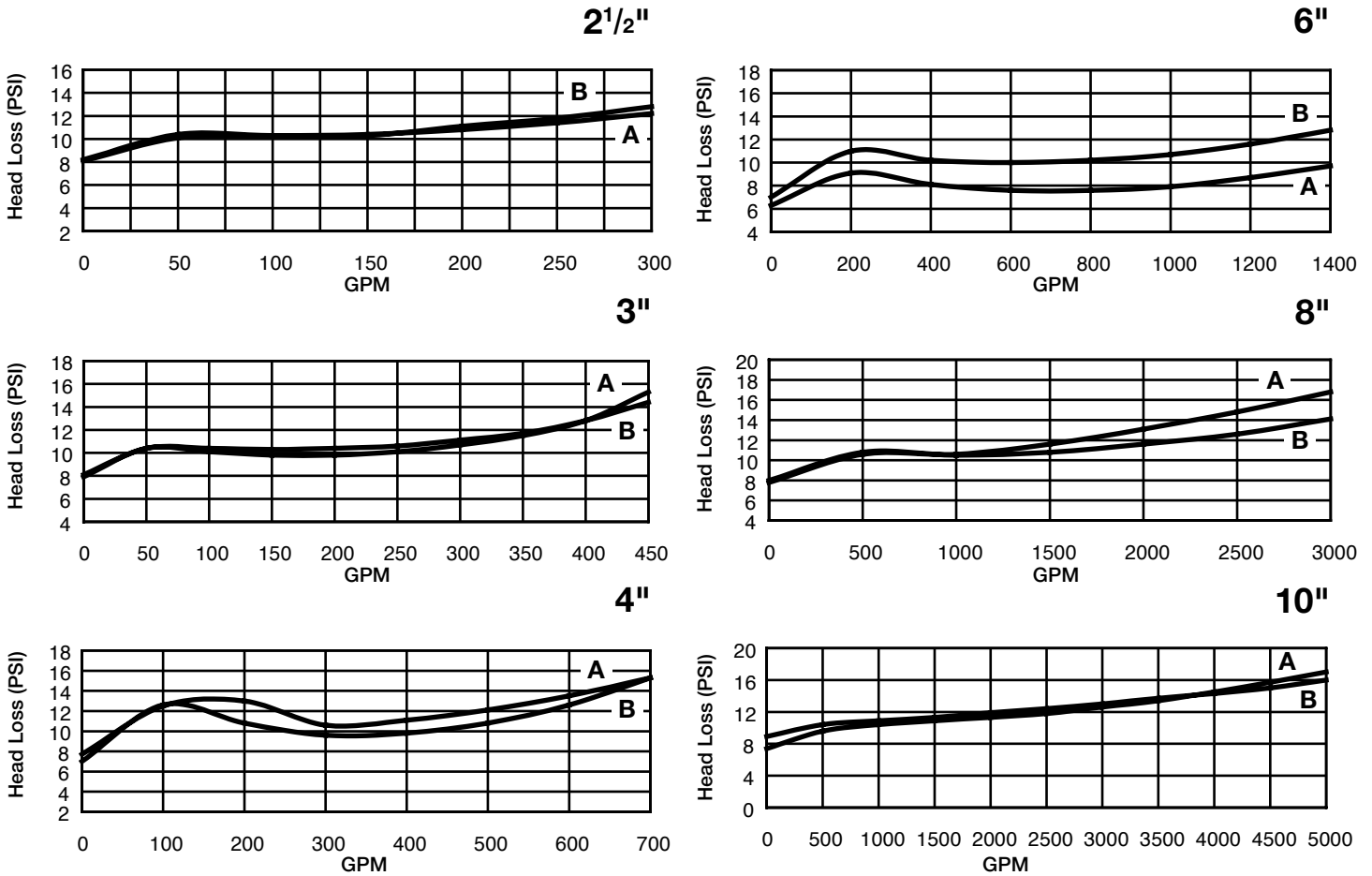

A-Vertical orientation (model 880V)
B-Standard orientation (model 880 and 880V)

The 6" and 10" flow curves (B-standard orientation) include the FEBCO valve setter model 611.



Distributed by:

Daniel L. Jerman Co.

275 Railroad Place

Hackensack, NJ 07601

Phone 800.654.3733

Fax 201.487.3953

International Phone 201.487.7444